



DigitroniK Digital Indicating Controller SDC10

The SDC10 is a group multi-range digital indicating controller with self-tuning (adaptive control).

A compact instrument (48W × 48H mm) featuring PID control, it can either be panel or socket mounted and the control outputs are either relay contact or voltage operated.



Specifications

General	Memory backup	Semiconductor non-volatile memory
	Power supply voltage	85 to 264Vac, 50/60Hz and 24Vdc
	Power consumption	7VA max.
	Ambient temperature	0 to 50°C
	Ambient humidity	10 to 90% RH (no condensation allowed)
PV Input	Weight	Socket type: approx. 300g, Mounting bracket type: approx. 200g
	Type	Thermocouple, RTD, Voltage
	Sampling cycle	0.5s
Indication & Setting	Bias	-1999 to +9999 or -199.9 to 999.9U (U: industrial unit)
	PV, SP indication	4-digit, 7-segment LED
	No. of set points	Max.4 points
	Range	± 0.5%FS ±1 digit, (T/C negative range is ± 1%FS + 1 digit)
Control Output	Indication accuracy	ON/OFF, self-tuning (adaptive control), or fixed PID control
	Control mode	Direct/reverse selectable
	Control action	Selectable by RDY key or remote switch input
Remote Switch(RSW) Input	RUN/READY	2
	No. of inputs	SP, READY/RUN, latch cancel, timer start, auto-tuning start/stop
Event(EV) Output	Function	Dry contact or open collector
	Type	2
	No. of outputs	Upper PV, Lower PV, Upper & Lower PV, Upper DEV, Lower DEV, Upper & Lower DEV, Heater Line break/over-current, Operation terminal short-circuit, Timer, Instrument alarm
Auxiliary Parts (order separately)	Type	Upper PV, Lower PV, Upper & Lower PV, Upper DEV, Lower DEV, Upper & Lower DEV, Heater Line break/over-current, Operation terminal short-circuit, Timer, Instrument alarm
	Control mode	ON/OFF
	Output type	SPST relay contact
Auxiliary Parts (order separately)	Q206A	Current transformer (5.8mm dia hole)
	Q212A	Current transformer (12mm dia hole)
Parts (order separately)	81446391-001	Mounting socket

Selection Guide

I II III IV V VI VII Example: C10S0DTA0000

Table		Selection			Description				
I	Basic Model No.	C10	↓	↓	Digital indicating controller				
II	Mounting	S	-	○	Socket mounting				
		T	○	-	Panel mounting				
III	Control output	0D	○	○	Time proportional PID or ON/OFF Relay contact: 250Vac, 3A (resistive load)				
		6D	○	-	Time proportional PID or ON/OFF 22.5Vdc ± 15%, internal resistive 1.1kΩ				
IV	PV input				Input type	Range		Range code	
					T/C	K	0 to 1200°C	0 to 2200°F	01
						K	0 to 600°C	0 to 1100°F	02
						K	0 to 400°C	0 to 700°F	03
						K	-200 to +400°C	-300 to +700°F	04
						J	0 to 800°C	0 to 1500°F	05
						J	-200 to +400°C	-300 to +700°F	06
						E	0 to 600°C	0 to 1100°F	07
						T	-200 to +400°C	-300 to +700°F	08
						DIN U	-200 to +400°C	-300 to +700°F	09
						DIN L	0 to 800°C	0 to 1500°F	10
						R	0 to 1600°C	0 to 3000°F	11
					RTD	Pt100	-200 to +500°C	-300 to +700°F	21
						Pt100	0 to 200°C	0 to 300°F	22
						Pt100	0.0 to 200.0°C	0.0 to 300.0°F	23
JPt100	-200 to +500°C	-300 to +700°F	24						
Voltage	JPt100	0 to 200°C	0 to 300°F	25					
	JPt100	0.0 to 200.0°C	0.0 to 300.0°F	26					
	Pt100	-50 to +100°C	-50 to +150°F	27					
	Pt100	-50.0 to +100.0°C	-50.0 to +150.0°F	28					
	JPt100	-50 to +100°C	-50 to +150°F	29					
	JPt100	-50.0 to +100.0°C	-50.0 to +150.0°F	30					
Programmable at - 19999 to + 9999	1 to 5V			42					
	0 to 5V			43					
	0 to 1V			44					
V	Power supply	A	○	○	85 to 264Vac, 50/60Hz				
		D	○	○	24Vdc				
VI	Option (1)	00	○	○	None				
		01	○	○	2 event (additional contact) relay outputs				
		02	○	-	2 event (additional contact) relay outputs, two external contact inputs and current transformer(heater current sensor) input				
		03	○	-	2 event (additional contact) relay outputs, 2 external contact inputs and current transformer (heat current sensor) input				
		05	○	-	RS-485 + 2 event (additional contact) relay outputs, current transformer (heater current sensor) input				
VII	Option (2)	00	○	○	Not available				

*The socket mounted type **S** cannot be combined with **6D** (control output) or with option **02** (event, external contact input and current transformer).

Dimensions (unit : mm)

Panel mounting type(T)

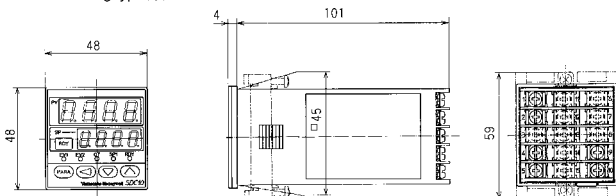

Socket mounting type(S)

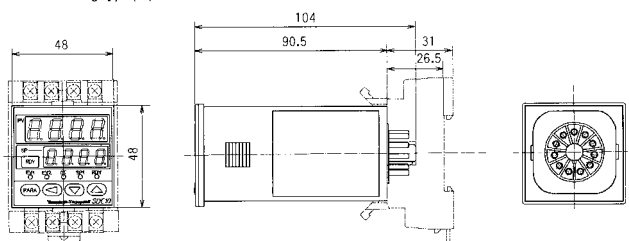

YAMATAKE

Yamatake Corporation

IBD Sensing and Control Department

Totate International Building

2-12-19 Shibuya Shibuya-ku Tokyo 150-8316

Phone:81-3-3486-2311 Fax:81-3-3486-2300

Savemation

Saving through Automation

Printed in Japan,(AB)

Issued 1 Oct.,1998

Rev 2 May.,2000